

Classe100 V16M Video internal unit with handset

344625

Description

2 WIRE video internal unit, with handset, for surface installation. It has a 4.3" (16:9) colour display. Available pushbuttons: auto-switching on, door lock release, staircase light control/various actuators. Depending on the configurator inserted in (M), the same pushbuttons will perform different functions (see the specific configuration section). LEDs for: call exclusion, communication with entrance panel. Side adjustment for: display colour and brightness as well as call exclusion/volume (16 different selectable tones). The surface installation must be made with the supplied metal base.

Technical data

BUS/SCS consumption:	18 – 27Vdc
Consumption at rest:	10 mA
Max. operating absorption:	200 mA
Operating temperature:	5 – 40°C

Dimensional data

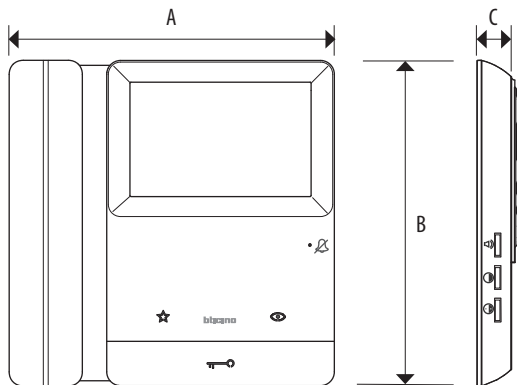

A	B	C
200 mm	200 mm	21 mm

Front view

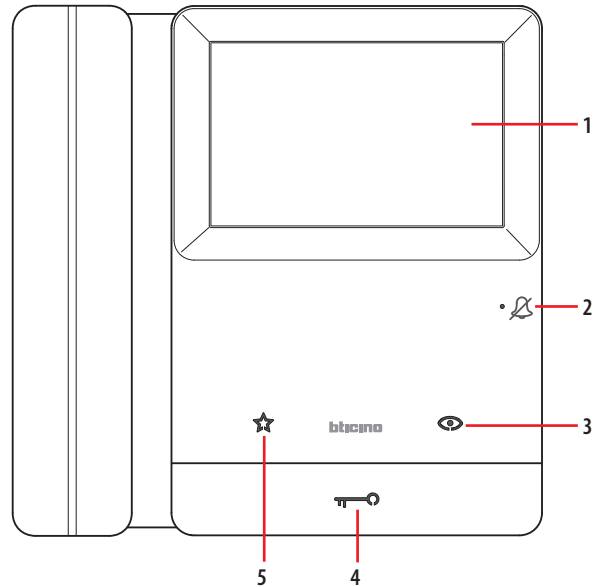

Legend

1. Display
2. Call exclusion/device status LED*
3. Auto-switching on/Scrolling key
Direct entrance panel activation (without call) / Cycling / Call to the switchboard (if applicable)
4. Door lock release pushbutton**
Direct door lock activation or activation of the door lock of the active entrance panel.
5. "Favourites" pushbutton (see M configuration mode)

Note: When pressed, keys 3/4/5 light up and emit a "beep" that cannot be disabled

*** Notification by means of two-colour LED of the operating status**

Red LED ON steady	bell exclusion
Red LED ON flashing	call bell selection
Green LED ON steady	communication in progress
Green LED ON flashing	incoming call

**** Notification by means of white LED of the door status**

LED ON flashing	door open
LED OFF	door closed

Side view

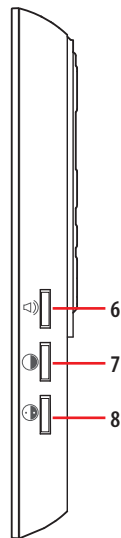

Rear view

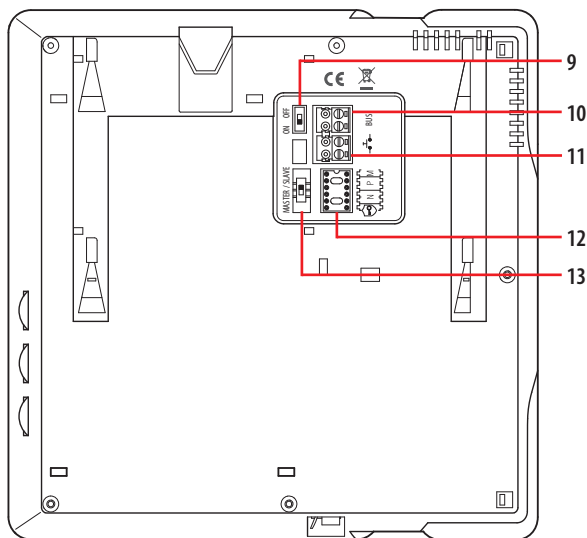

Legend

- 6. Volume adjustment and bell exclusion
- 7. Image brightness adjustment
- 8. Image colour adjustment
- 9. ON/OFF micro-switch for the closure of the line at the last internal unit of the riser or leg.
Switch to ON if the device is the last of the riser or leg
- 10. BUS connection clamp
- 11. Call to the floor pushbutton
- 12. Configurator socket
- 13. "Master/Slave" selector

Configuration

The device must be only physically configured.

N - Internal unit number

The configurators inserted in the N socket of the internal unit assign a system identification number. The internal units must be configured in progressive order. Internal units with parallel connection (max 3 inside apartments without item 346850) must be configured using the same N configurator. In parallel additional audio and video internal units may be installed.

P – Entrance panel association

The configurators connected to the P socket of the internal unit assign the associated EP, the first entrance panel that switches on with the auto-switching on pushbutton and which door lock is activated when pressing the door lock pushbutton while the internal unit is idle.

Configurator socket

 Safe door lock	It allows the opening of the door lock only if the entrance panel and the internal unit are communicating. Connect the JMP* configurator to activate the function. Note: this function does not allow the operation of the door lock pushbutton when idle, or the "Favorites" key (only if M = 1) when idle.
NN	Internal unit address.
PP	Entrance panel address with activation in idle condition and direct auto-switching ON.
M	Operating modes: ☆ Mod 0 = Staircase Light Activation. Mod 1 = direct entrance panel door lock opening (configured with P+1) without call, or activation of the actuator item 346210 (configured with P+1 and MOD=5), or activation of door lock actuator item 346230 (configured with P+1). Mod 2 = Automatic activation of the EP (configured with P+1) camera, directly without call, or activation of the actuator item 346210 (configured with P+1 and MOD=9). Mod 3 = Intercom among internal units; it sends calls to internal units configured with the same address. Mod 4 = General intercom. It sends a call to all the internal units of the system. Mod 5 = Intercom among configured internal units N=1 N=2. N=1 sends a call to N=2. SN=2 sends a call to N=1. Mod 6 = Predefined intercom. "Preset intercom" function with intercom call to the Internal Unit configured with N=1. It is possible to send an intercom call from the system Internal units to the internal unit configured with N= 1. The internal unit configured with N=1 receives Intercom calls but cannot send them.

* Note: the JMP configurator (item 3501/JMP) is not supplied.

Door Status Function

This function indicates the status of the door lock: when open, the "door lock LED" flashes, when closed, it's off (only for systems with door locks or actuators intended for this function).

Bell programming

The video internal unit offers the possibility to select among 16 types of bells with programmed ringtones, which can be freely associated to the following type of calls:

- Calls from the entrance panel (configured with S=0);
- INTERCOM call;
- Floor call.

The general call bells coming from the EP configured with S=1, S=2 & S=3 are configured as default and cannot be changed.

Call bell selection

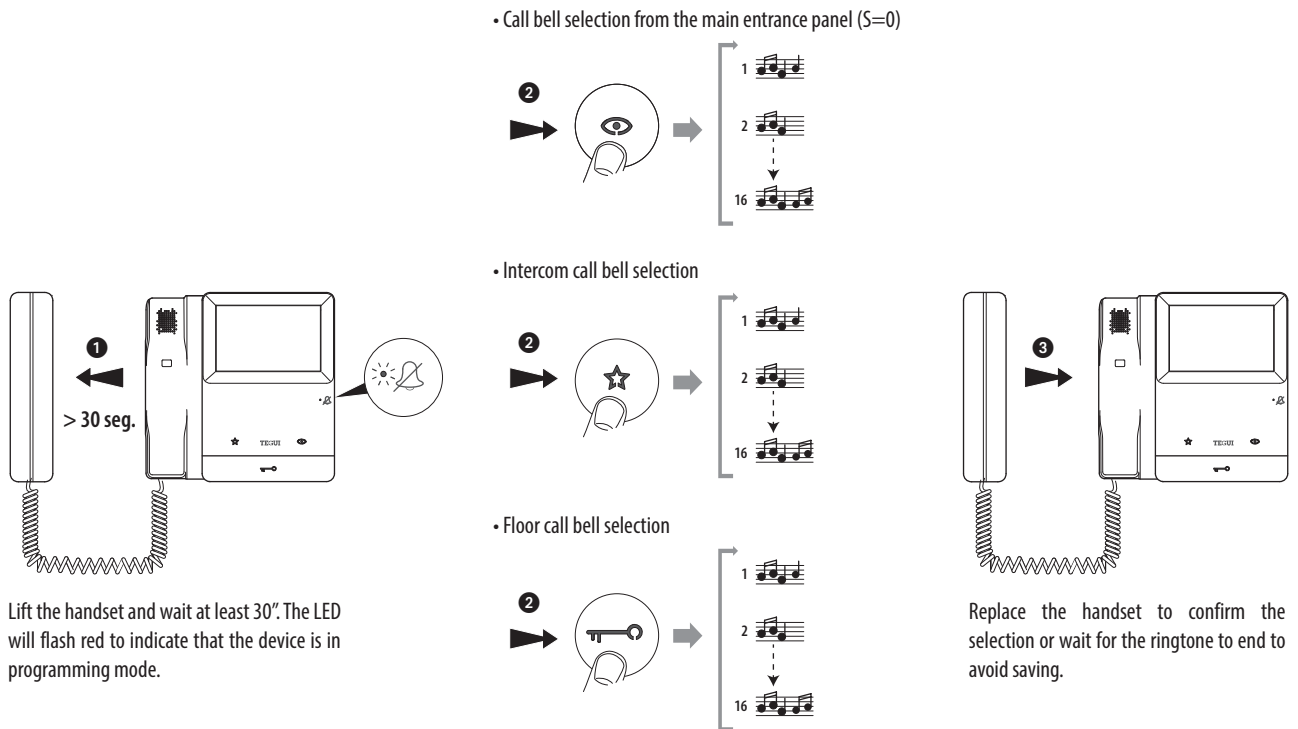

Note: if no action is performed during call ringtone selection mode for more than 20", the device returns to normal operating mode.

 When selecting the call ringtone, do not move the handset close to your ear.